

ABELL
SURVEYING & MAPPING
1140 SEQUOIA STREET • DELAVAN, WISCONSIN 53115
262-728-6737

McDOWELL

STREET

MAIN STREET

WIDE

82.5'

91.46'

MAIN STREET

80°07'21"

82.5'
90.76'

WIDE

LOT 2
AREA 0.19 ACRES

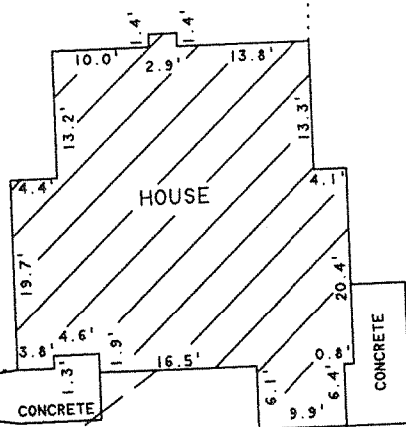

CONCRETE WALK

CONCRETE

HOUSE

BLACKTOP DRIVE

89°53'37"

IRON PIPE FOUND 0.24' NORTH
AND 0.03' WEST OF CORNER
UNABLE TO LOCATE IRON ROD AS
SHOWN ON SURVEY BY THIS OFFICE
DATED OCTOBER 19, 1993.

241.96'
(242.04')

GARAGE WEST OF LINE 0.2' EAVES
EXTEND OVER LOT LINE 0.7'

91.46'

22.5'

14.4'

GARAGE WEST OF LINE 0.1' EAVES
EXTEND OVER LOT LINE 0.8'

50°06'23"

42.41'

LOT 8

LOT 3

PLAT OF SURVEY OF

LOT 2, BLOCK 8 OF THE ORIGINAL PLAT
OF THE CITY OF DELAVAN, WALWORTH
COUNTY, WISCONSIN.

ORDERED BY: CLAIR LAW OFFICE
P.O. BOX 445
DELAVAN, WI 53115

NOTE: DIMENSIONS USED FOR BLOCK 8 WERE
TAKEN FROM CITY ENGINEERS RECORDS
ON FILE AT CITY HALL (DELAVAN, WI.)

REVISED AND RECERTIFIED: JUNE 30, 2008
ORDERED BY: SHIRLEY MARTIN
P.O. BOX 81
DELAVAN, WI. 53115

N



SCALE 1"=20'

LEGEND

- - IRON PIPE FOUND
- - CONCRETE MONUMENT FOUND
- - IRON ROD SET, found 6-30-08
- * - WOOD FENCE
- - OVERHEAD UTILITY LINES
- () - AS SHOWN ON CITY ENGINEERS RECORDS

I HEREBY CERTIFY THAT I HAVE SURVEYED THE ABOVE DESCRIBED PROPERTY AND THAT THE ABOVE MAP IS A TRUE REPRESENTATION THEREOF AND SHOWS THE SIZE AND LOCATION OF THE PROPERTY, ITS EXTERIOR BOUNDARIES, THE LOCATION OF ALL VISIBLE STRUCTURES AND DIMENSIONS OF ALL PRINCIPAL BUILDINGS THEREON, BOUNDARY FENCES, APPARENT EASEMENTS, ROADWAYS AND VISIBLE ENCROACHMENTS, IF ANY, TO THE BEST OF MY KNOWLEDGE AND BELIEF.

THIS SURVEY IS MADE FOR THE USE OF THE PRESENT OWNERS OF THE PROPERTY, AND ALSO THOSE WHO PURCHASE, MORTGAGE, OR GUARANTEE THE TITLE THERETO WITHIN ONE (1) YEAR FROM DATE HEREON.

David F. Abell

DAVID F. ABELL
WISCONSIN REGISTERED LAND SURVEYOR, S-1596

October 19, 1993

DATE: JOB NUMBER - 93233A
NOTE: THIS IS NOT A CERTIFIED COPY UNLESS SEALED.

XDP-43

002-2440